



48 Fairwood Road, Cardiff

Cardiff

In Excess of **£150,000**





48 Fairwood Road

Cardiff, Cardiff

This two-bedroom first-floor maisonette is located on a quiet road, just half a mile from Danescourt station. It is privately accessed via side steps, leading to an entryway that opens to the kitchen and bathroom, both updated in the last few years.

Council Tax band: C

Tenure: Leasehold

EPC Energy Efficiency Rating: C

EPC Environmental Impact Rating: C

- Two Generous Bedrooms
- Recently Fitted Shower Room
- Quiet Cul-De-Sac
- Lease Extension on Completion

Hallway

The property is privately accessed on the first floor via side steps leading to a UPVC front door with two frosted glass panels. The entrance area features a wall-mounted radiator, ceiling light point, wood-effect flooring, and provides access to the kitchen, lounge/diner, and shower room.

Kitchen

The kitchen, recently updated, features white gloss wall and base units with wood-effect countertops. It includes an inset sink and draining board with mixer tap, gas hob, extractor fan, electric oven, and space for additional appliances. There is a double-glazed front window, ceiling light, multiple power points, and wood-effect flooring extending from the entrance.

Shower Room

The recently updated shower room features a three-piece suite. The walk-in shower includes a fitted shower tray with a glass-panelled surround and sliding door, panelled back wall, and a wall-mounted thermostatic shower attachment. Additionally, there is a washbasin with vanity unit and mixer tap, and a low-level WC with push-button flush. The bathroom has tiled flooring, partially tiled walls with a mosaic strip, a wall-mounted radiator, a double-glazed side window, and a ceiling light.

Lounge

The lounge is a bright space with a feature fireplace and a large double-glazed front window. It includes a wall-mounted radiator, ceiling light, and multiple power points.

Hallway

The hallway, accessed off the lounge diner, gives access to both bedrooms and is fitted with a ceiling light point.

Bedroom One

The main bedroom comfortably fits a double bed and features a double-glazed front window, wall-mounted radiator, ceiling light point, and multiple power points.

Bedroom Two

The second bedroom is a good sized single with a double-glazed front window, wall-mounted radiator, ceiling light point, and multiple power points.



Approx Gross Internal Area
58 sq m / 620 sq ft

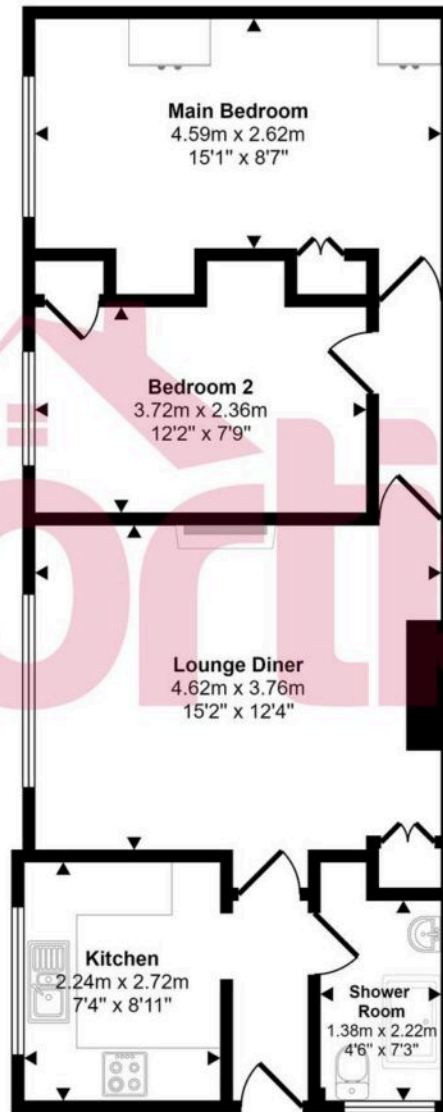

Floorplan

This floorplan is only for illustrative purposes and is not to scale. Measurements of rooms, doors, windows, and any items are approximate and no responsibility is taken for any error, omission or mis-statement. Icons of items such as bathroom suites are representations only and may not look like the real items. Made with Made Snappy 360.