



**14 Greenland Crescent, Cardiff**  
Cardiff

£145,000

**FORTIS**  
Estate Agents



## 14 Greenland Crescent

Cardiff, Cardiff

Stylish ground floor flat with two double bedrooms, modern kitchen, high-spec bathroom, quality finishes and long lease. Ideal for sharers, couples or investors in a convenient location.

Council Tax band: C

Tenure: Leasehold

EPC Energy Efficiency Rating: D

EPC Environmental Impact Rating: D

- Ground Floor Apartment
- Two Double Bedrooms
- Beautifully Appointed Bathroom
- Modern Fitted Kitchen
- Long Lease



### Entrance Hall

Accessed via front door, wood effect flooring, radiator, ceiling light point, doors to:

### Kitchen

A beautifully appointed kitchen, fitted with a matching range of wall and base level cupboard and drawer units with work surfaces over, inset sink and drainer with mixer tap, integrated electric oven and hob, cooker hood above, space for appliances, double glazed window to the front.

### Living Room

A good sized lounge with double glazed window to the side and front, ceiling light point, wood effect flooring, radiator.

### Main Bedroom

A good sized double bedroom with double glazed side and rear aspect window, ceiling light point, built in wardrobes, radiator.

### Bedroom Two

A good sized double bedroom with double glazed rear aspect window, ceiling light point, radiator.

### Bathroom

A beautifully appointed bath, fitted with a modern three piece suite comprising panel enclosed bath with tiled surround, and shower over, low level WC, vanity unit with inset sink and storage cupboards beneath, tiled flooring, double glazed rear aspect window x 2, ceiling spot lights, chrome effect heated towel rail.





### Entrance Hall

Accessed via front door, wood effect flooring, radiator, ceiling light point, doors to:

### Kitchen

A beautifully appointed kitchen, fitted with a matching range of wall and base level cupboard and drawer units with work surfaces over, inset sink and drainer with mixer tap, integrated electric oven and hob, cooker hood above, space for appliances, double glazed window to the front.

### Living Room

A good sized lounge with double glazed window to the side and front, ceiling light point, wood effect flooring, radiator.

### Main Bedroom

A good sized double bedroom with double glazed side and rear aspect window, ceiling light point, built in wardrobes, radiator.

### Bedroom Two

A good sized double bedroom with double glazed rear aspect window, ceiling light point, radiator.

### Bathroom

A beautifully appointed bath, fitted with a modern three piece suite comprising panel enclosed bath with tiled surround, and shower over, low level WC, vanity unit with inset sink and storage cupboards beneath, tiled flooring, double glazed rear aspect window x 2, ceiling spot lights, chrome effect heated towel rail.



Approx Gross Internal Area  
58 sq m / 628 sq ft

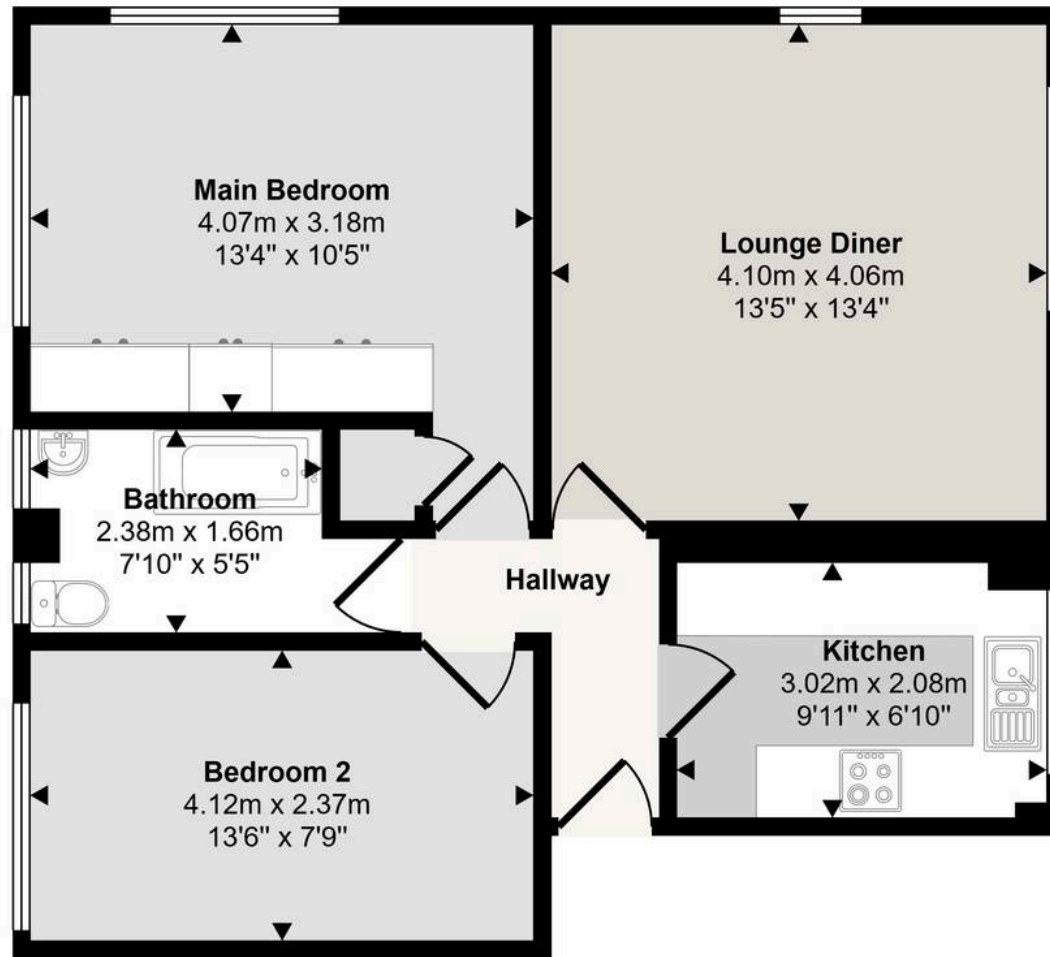

Floorplan

This floorplan is only for illustrative purposes and is not to scale. Measurements of rooms, doors, windows, and any items are approximate and no responsibility is taken for any error, omission or mis-statement. Icons of items such as bathroom suites are representations only and may not look like the real items. Made with Made Snappy 360.

